

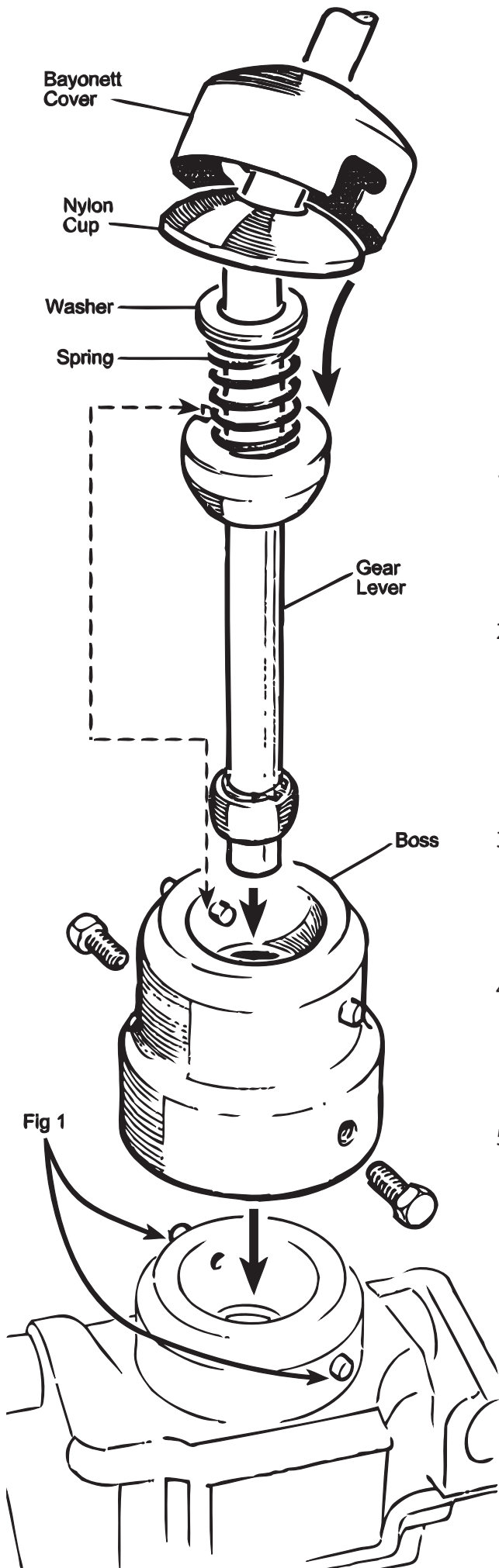

Quickshift

Fitting Instructions (for rod change)



- 1 Remove original gear lever from the housing. Using vice grips, remove locating pins from the housing neck (Fig 1)
- 2 Place new lever boss into position on housing and secure by tightening the two bolts on the outer edge into the two holes left in the housing neck. Locating pin to be positioned on the RH side of the car.
- 3 Cut the original lever to allow removal of the nylon cup, washer and spring. Place the cup, washer and spring into position on the new lever.
- 4 Place the bayonet cover over the nylon cup and refit into the new lever boss, in the same way as the original lever was fitted.
- 5 Check the selection of all gears. If you have a problem selection reverse gear, the spring under

Mini Sport Ltd.

Thompson Street,
Padiham, Lancashire,
England. BB12 7AP

Tel:- 01282 778731
www.minisport.com

Fax:- 01282 772043
sales@minisport.com